

2000 to 2004



*MEDIUM DUTY*

*STAINLESS STEEL V-BOTTOM SPREADERS*

**Parts List  
&  
Service Manual**

MFG BY : SMITH METAL WORKS OF NEWARK , INC.  
ROUTE 31 EAST  
NEWARK , NEW YORK 14513  
PHONE : (315) 331-1651  
FAX : (315) 331-0910

ALL Stainless Steel "V" Bottom Spreaders come equipped with a name plate attached to it. The model and serial numbers are stamped on the name plate. Always use the model and serial numbers in all correspondence regarding parts and or operation .

# OPERATING INSTRUCTIONS

## STAINLESS STEEL V-BOTTOM SPREADERS

### Safety:

1. Insure that all personnel involved with operation and maintenance of the Smith Stainless Steel Spreader are properly instructed.
2. Always disconnect all power sources before servicing.
3. Always use sander tie downs when transporting or operating the machine.
4. Keep limbs free of pinch points and moving parts when operating the spreader.
5. Avoid wearing loose clothing which could become entagled in moving parts.
6. Insure all personnel are clear when loading and unloading spreader.
7. Read operating instructions completely before operating spreader,
8. When traveling, especially fully loaded, this spreader may have a high center of gravity, and care should be exercised when turning or driving on banked surfaces.
9. When loading and unloading of unit use lifting rings provided on hopper side. Only attempt to lift the unit when the hopper is empty. NEVER STAND BENEATH a spreader being lifted.

### Installation Instruction:

1. Attach lifting chains or cables to the lifting rings provided on the hopper sides. Place the spreader on the truck centered and as far forward as possible. Tie down the spreader with chains to lift hooks or with optional tie downs.

### Operating Instructions:

1. Once your spreader is properly installed, we recommend a "dry run" with the hopper empty. Check for any obvious poor or faulty operation.

2. Load the hopper with your desired material and adjust the spreader for proper "spread". Volume is controlled by the sluice gate opening, while the direction and range is controlled by position of the internal chute and external deflectors. Always observe all safety rules when performing adjustments.
3. An inverted "V" is included as standard equipment . The purpose of the inverted "V" is to reduce load down pressure on the conveyor there by easing start-up power requirements . If the load exhibits excessive "bridging", the operator may elect to remove the inverted "V" sacrificing power consumption for improved product flow. In order to reduce power consumption on start-ups it is recommended that payload not be left in hopper over extended period. (This might cause material freeze up.)

### **Maintenance:**

1. Proper scheduled and performed operator maintenance is the key for successful operation.
2. Proper lubrication consists of keeping all grease fittings serviced. Also insure that the lubricant level in the gearbox is at the check plug level. (Use sae weight gear oil in the gearbox.)
3. Frequent lubrication of the roller chain is also recommended.
4. Cleanliness of the unit helps minimize friction. Always flush off the unit after operation to prevent build-up and binding.
5. Proper adjustments will keep the unit operating freely. Provide only the necessary conveyor chain tension to maintain smooth operation. Excessive chain tension could result in overloading.

### **Off-Season Maintenance (Summer Storage)**

1. Thoroughly flush the entire unit clean of salt and sand. Lube all bearings and check gearbox oil level. We strongly recommend removal of conveyor chain and store immersed in oil. Failure to remove and thoroughly lubricate chain may result in an inoperative spreader next season.

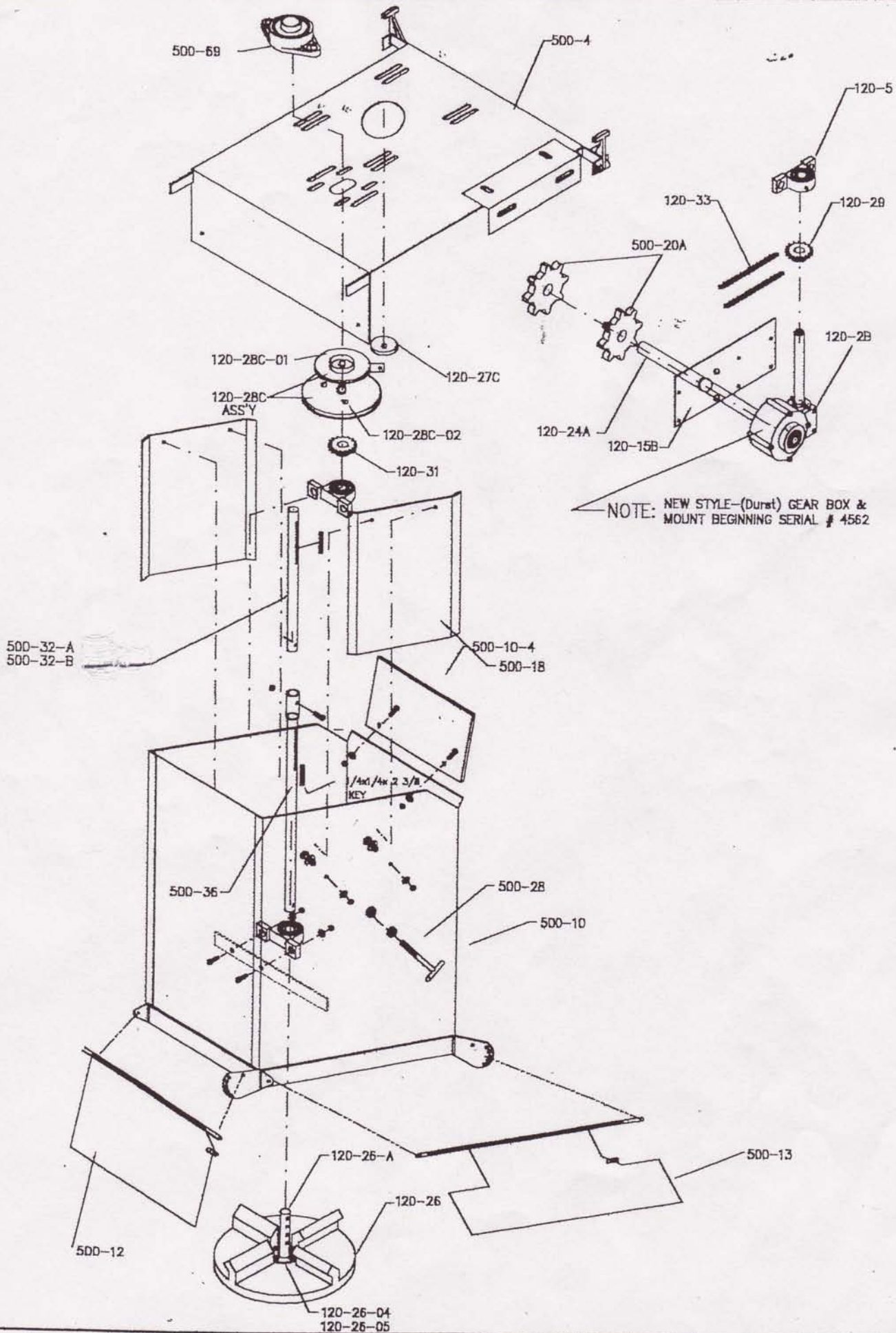

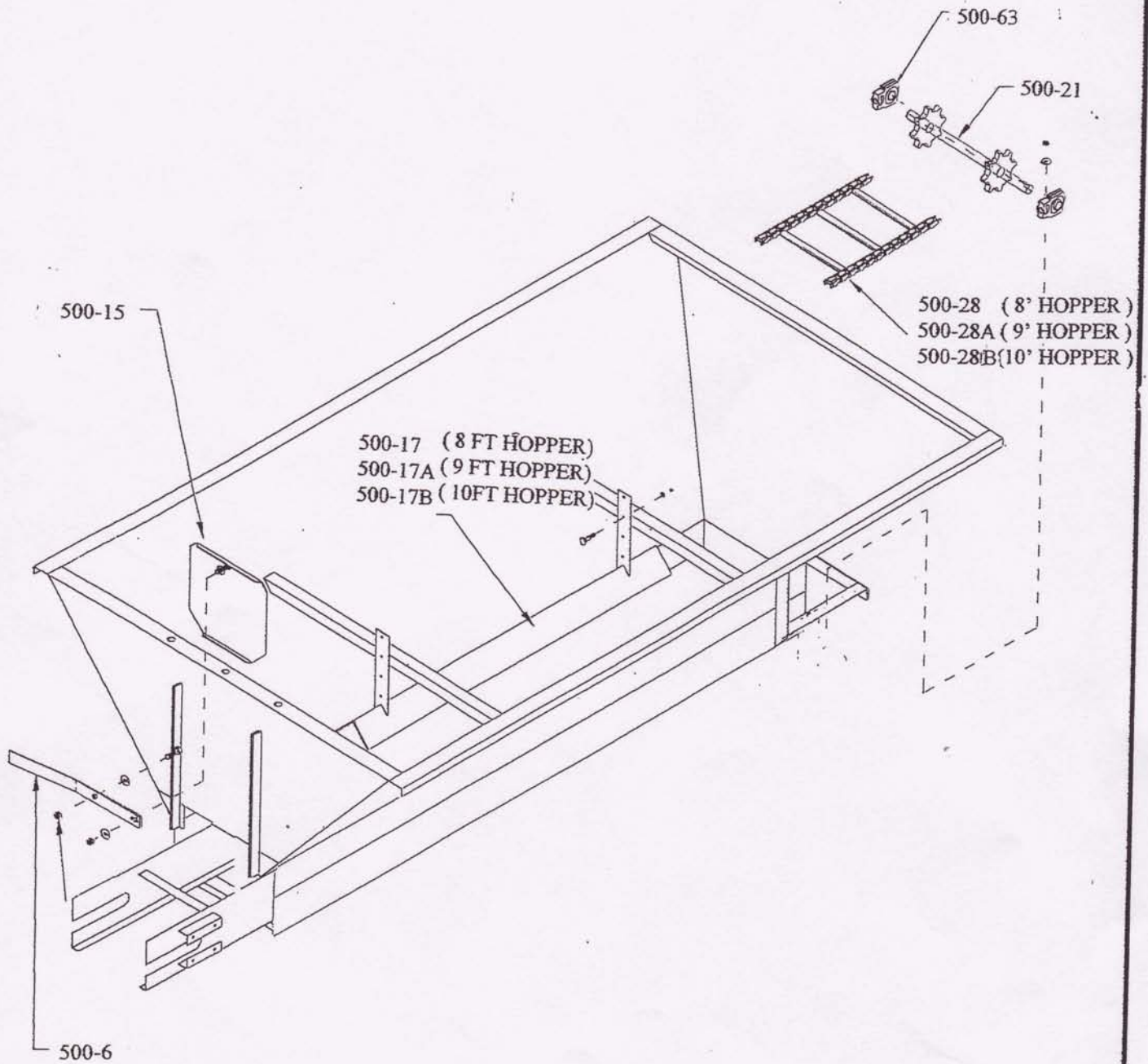

CANIMEX 8039 GEARBOX - HOLLOW BORE  
PARTS LIST

P/N 500-2

ITEM	DESCRIPTION	QTY
1	OIL SEAL	1
2	TAPERED ROLLER BEARING 30305 (25.4mm)	2
3	WORM GEAR	1
4	SQUARE KEY $\frac{1}{4} \times \frac{1}{4} \times 1\frac{1}{2}$	1
5	PLUG $\frac{3}{8}$ PT	1
6	BOLTS (M10x1.5 x 20L)	4
7	OUTPUT COVER	1
8	PLUG $\frac{1}{4}$ PT	7
9	HOUSING	1
10	INTERNAL CIRCLIP R62	1
11	INPUT WORM SHAFT	1
12	GREASE FITTING	1
13	BOLTS (M8x1.25 x 20L)	3
14	INPUT COVER	1
15	TAPERED ROLLER BEARING 30206	2
16	OIL SEAL 30 x 62 x 8, DOUBLE LIPS	1
17	SQUARE KEY $\frac{1}{4} \times \frac{1}{4} \times 7\frac{3}{4}$	1
18	GASKET	1

